

- **Body** Stainless Steel  
ASTM A351 CF 8M
- **Shaft** Stainless Steel  
ASTM A276 F316
- **Disc** Stainless Steel  
ASTM A351 CF 8M
- **Seat** RPTFE (PTFE + 25% GLASSFIBER)  
+ ASTM A182 F316
- **Packing** Graphite
- **Temperature** -50°C up to +220°C
- **Suitable pressure** ≤ 25 bar

- **Tolerances** ISO 2768-M
- **Face to Face** EN 558 Series 20  
ISO 5752 Series 20  
API 609 Table 1  
BS 5155 Series 4
- **Pressure test according to standards** API 598  
ISO 5208:  
Body: 1.5 × PN  
Seat: 1.1 × PN
- **Mounting between flanges** PN10/16  
ISO 7005, EN 1092, BS 4504  
ANSI class 150: ANSI B16.5  
ANSI class 300
- **Tightness test** ISO 5208, zero leakage  
API 598
- **PED** 2014/68
- **Atex** 2014/34/UE – Atex II 2GDc
- **Fire Safe** ISO 10497-2010
- **TA-LUFT and ISO 15848** TA-LUFT  
ISO 15848
- **SIL** IFC 61508  
SIL 2 (Low demand mode)  
SIL 3 (Under consideration of the minimum required hardware fault tolerance HFT=1)
- **Leak class** Class VI  
ISO 5208 (RATE A)

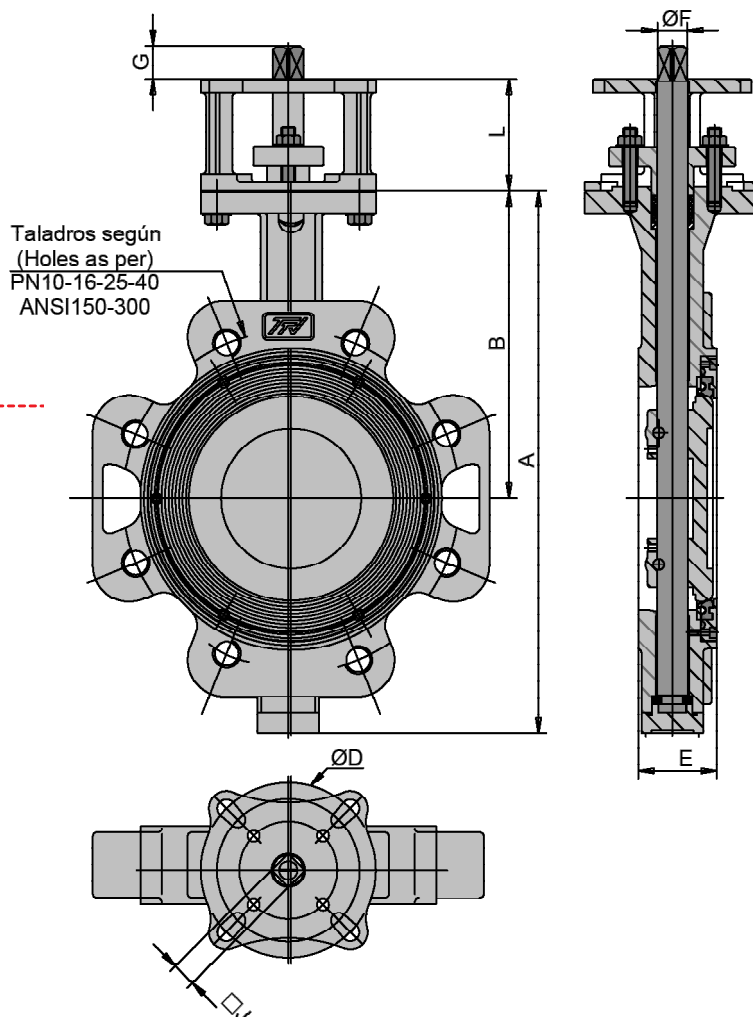

#### ► Pressure-Temperature Rating

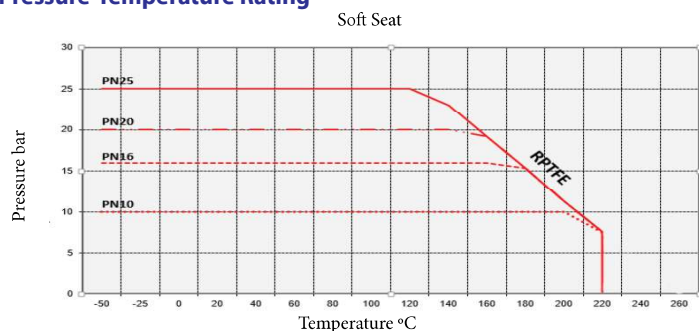

DN		A	B	D	E	F	G	J	L	ISO 5211	Weight Kg
mm	inch										
40	1½"	181	121	86	33	10	14	9	70	F05-07	3.1
50	2"	218	128	86	43	12	14	9	70	F05-07	4.6
65	2½"	228	140	86	46.5	14	14	11	70	F05-07	5.3
80	3"	259	148	86	47	17	15	14	70	F05-07	6.4
100	4"	295	169	86	52	17	18	14	70	F05-07	8
125	5"	350	200	125	56	21	22	17	80	F07-10-12	14
150	6"	388	220	125	56	21	24	17	80	F07-10-12	16
200	8"	450	250	150	63	26.5	32	22	90	F10-12-14	26
250	10"	523	286	175	71	26.5	39	22	106	F12-14-16	42
300	12"	606	328	175	78	33	50	27	106	F12-14-16	58
350	14"	661	355	175	78	36	50	27	106	F12-14-16	64
400	16"	704	370	175	102	50	50	-	120	F12-14-16	103
450	18"	755	400	175	114	50	80	-	106	F12-14-16	125
500	20"	830	450	155	127	60	80	-	120	F14-16	162
600	24"	970	510	155	154	60	90	-	120	F14-16	271

(\*)PN25 cannot be manufactured in DN300

(\*)PN40 cannot be manufactured in DN250, DN300, DN350, DN400, DN450, DN500 & DN600

(\*)ANSI300 cannot be manufactured in DN150, DN250, DN300, DN350, DN400, DN450, DN500 & DN600